

INSTALLATION INSTRUCTION

Integral LED COMPACT TOUGH IP65 batten

5 Year Warranty

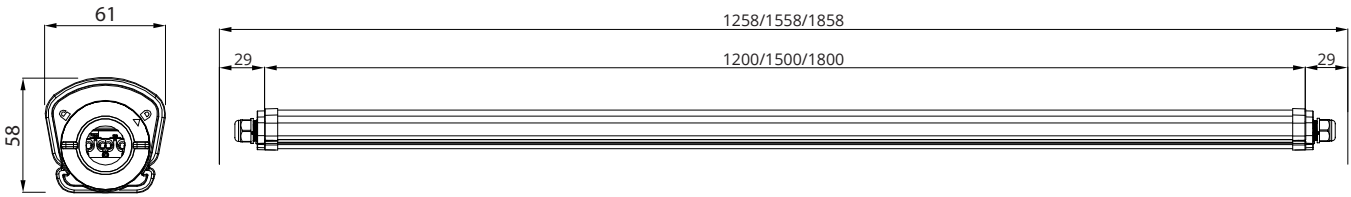

Product code	Description
ILBTS040	4FT COMPACT ECO IP65 BATTEN 4FT WATTAGE ADJUSTABLE 20/35W 2800LM-4200LM 120LM/W 4000K LINKABLE
ILBTS050	5FT COMPACT ECO IP65 BATTEN 5FT WATTAGE ADJUSTABLE 30/50W 4200LM-6000LM 120LM/W 4000K LINKABLE
ILBTS060	6FT COMPACT ECO IP65 BATTEN 6FT WATTAGE ADJUSTABLE 40/58W 5600LM-6960LM 120LM/W 4000K LINKABLE

Thank you for purchasing an INTEGRAL LED product. When installed correctly this unit will provide years of service – with no lamp changes required. For support or warranty information please see integral-led.com. Always turn off circuit power at the distribution unit before installation and maintenance. Please ensure that the power cannot be connected inadvertently.

Important Details – Please read prior to installation

Ensure the AC/Mains power is NOT connected and cannot be unexpectedly reconnected during installation.

1. This product must be installed by a qualified electrician in accordance with instructions provided and in compliance with recognised electrical and safety regulations relevant to the country it is being installed.
2. This product is suitable for installation on surfaces with normal flammability e.g. wood, masonry. It is not suitable for use on highly flammable surfaces or in flammable atmosphere.
3. This product must be securely fixed to the mounting surface using the fixings clips, screws and wall plugs supplied. The screws and wall plugs are suitable for “masonry” only. Other fixings are not supplied and must be purchased.
4. Please use the cable gland supplied in the box if the LED batten is required to be linked.
5. Connect the power lead to a suitable junction box to maintained IP rating.
6. Recommended cable H05RN-F 3x1.00mm².
7. Please use the protective cover on any unused connector.
8. Maximum no of units in series is 10 using recommended cable.
9. This product is not suitable for dimming.

IMPORTANT! This product is a Class II device.

Warranty

This unit carries a 5 year warranty from the date of purchase, providing that it has been installed correctly and not modified in any way. Should a fault occur please contact the original place of purchase.

Important Notes

Operating and storage of luminaire must be within rated temperature and humidity guidelines. Operation must be within rated input voltage.

- Keep away from strong electromagnetic radiation sources and protect from lightning strike.
- Should the unit malfunction, return to distributor or reseller. No user serviceable parts inside. Risk of electric shock, do not disassemble or attempt to repair the luminaire.
- Do not install or use the luminaire if the casing is found to be broken.
- The luminaire must be installed by a qualified electrician.
- The luminaire should be positioned away from heat and vibration. Avoid contact with any corrosive chemicals.
- The luminaire should be mounted in free air it is recommended not to exceed 30° C ambient.
- Never cover the luminaire with heat insulation materials.
- The luminaire should be positioned at least 1 metre away from radios, failure to do so may affect radio reception.

Rotate and remove round cap on the side.

Power cord go through the round cap, inserted into corresponding

Step 4: Push the terminal/connector back into fixture, put on the the round cap and rotate it to lock position.

Step 5: Wire the other side by repeat procedure 1-4, to reach connection through wiring.

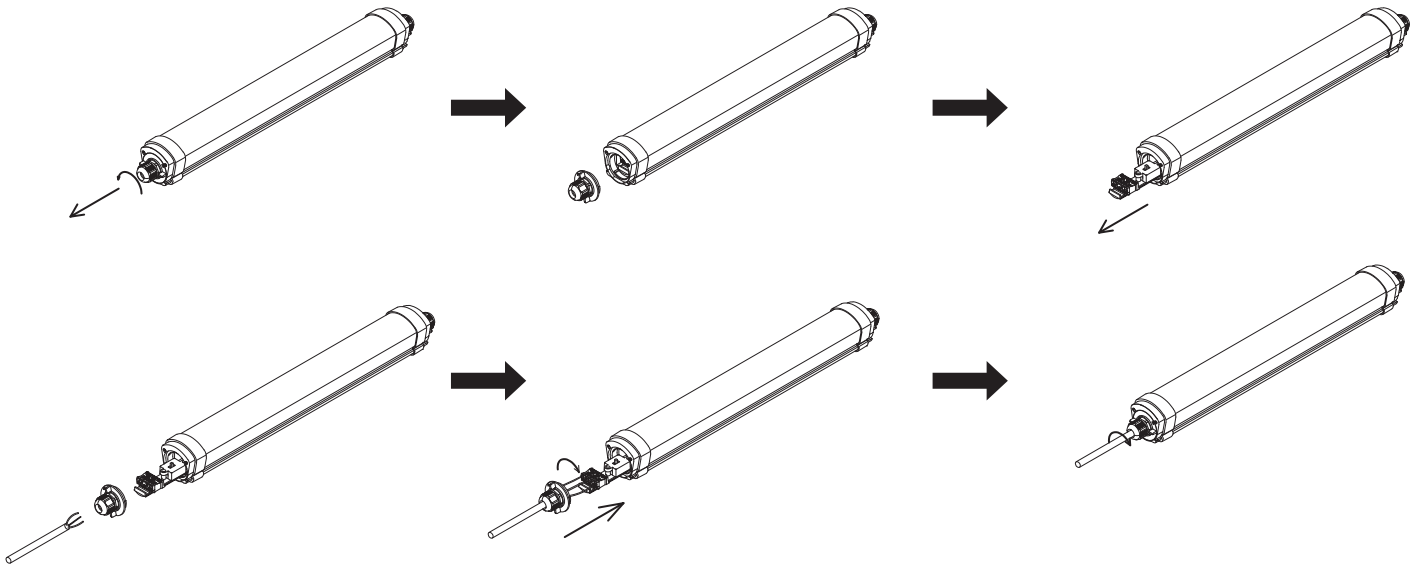

Make a right position and screw hole on the ceiling, screw the clip on the ceiling tightly.

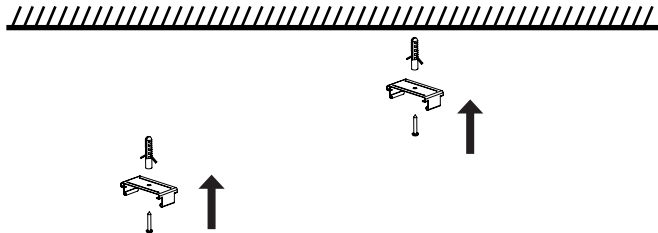

Snap the lamp into clips. The installation is finished.

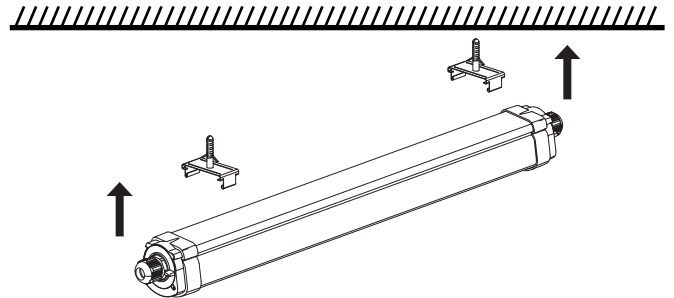

Make a right position and screw hole on the ceiling, then install the expansion.
Steel wire rope go through the clips, and insert into expansion.

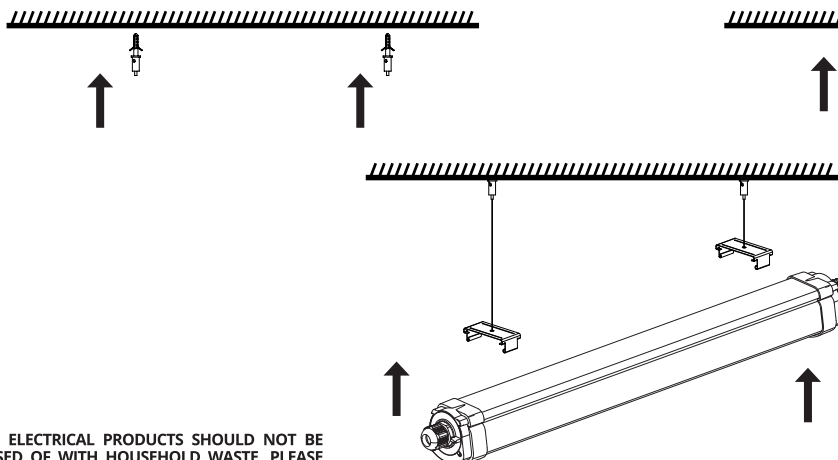

Snap the lamp into clips, and adjust the length of wire rope according to need. The installation is finished.

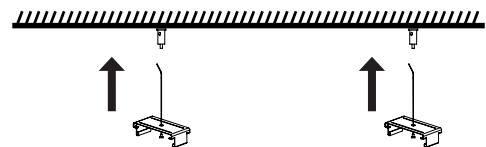

WASTE ELECTRICAL PRODUCTS SHOULD NOT BE DISPOSED OF WITH HOUSEHOLD WASTE. PLEASE RECYCLE WHERE FACILITIES EXIST. CHECK WITH YOUR LOCAL AUTHORITY FOR RECYCLING ADVICE.

* Requires suspension kit ILBASK091 supplied separately

