

Exterior Garden Lights - Low Voltage LED Festoon Lights

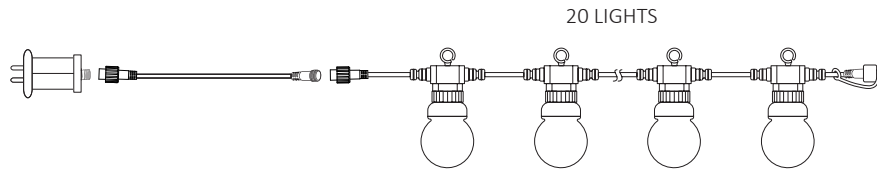

1

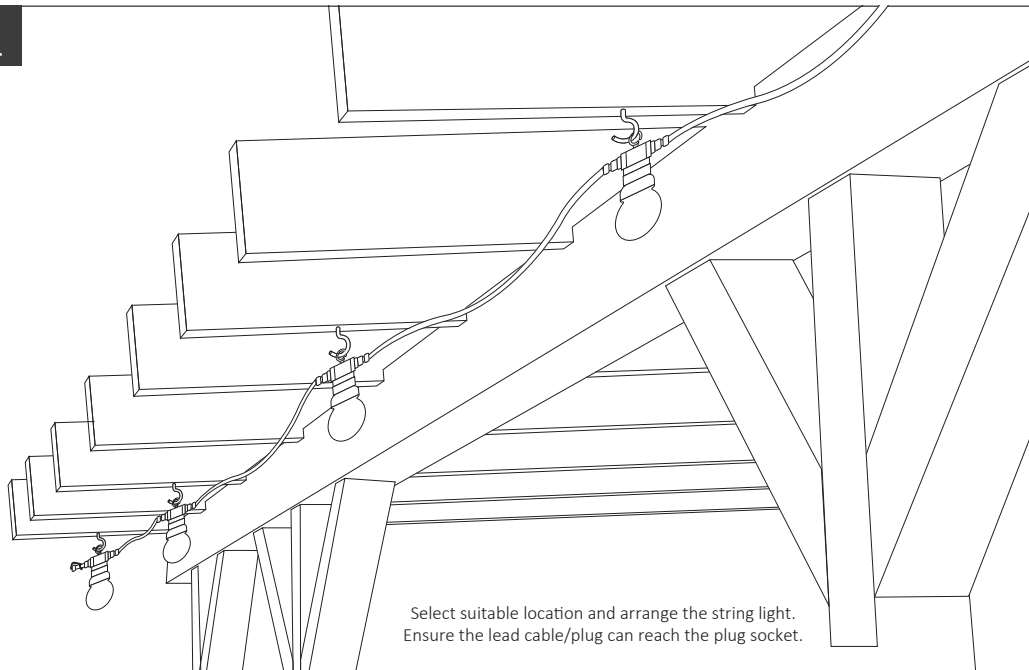

2

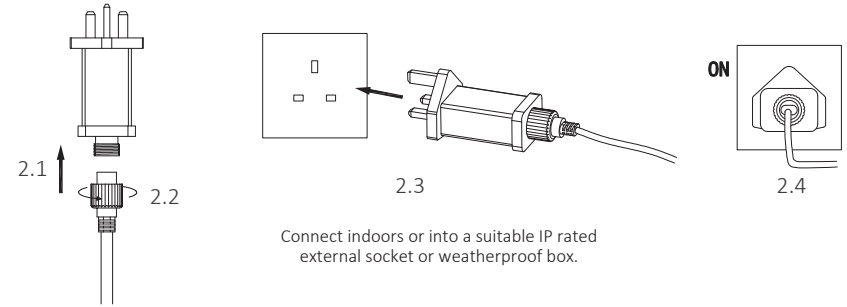

3

To Extend Second Set of Festoon Lights

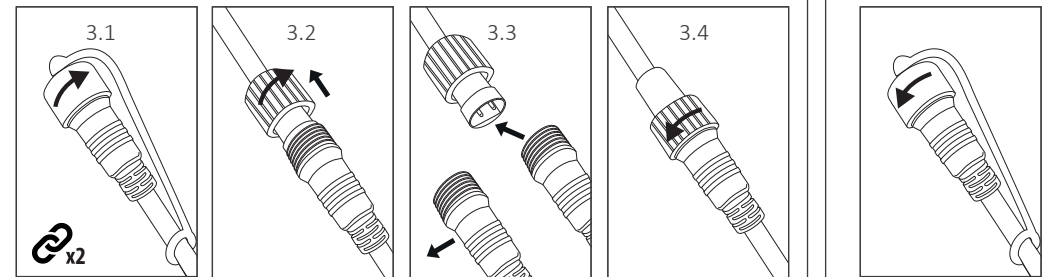

To link another set of string lights. On the first string remove the waterproof cover at the end of the cable.

On the second string loosen the connecting cap in-between the transformer and first light and separate.

Attach the exposed male and female sockets to connect the 2 strings.

Secure the connecting cap over the linked strings. You can link 2 sets of lights together.

Attention: End connector must be always covered to avoid potential risks.

IMPORTANT

- The light string is IP44 (not including transformer) is suitable for indoor or outdoor use. But should not be immersed in water or exposed to water jets (e.g. pressure waters). The Transformer is IP20 is suitable for indoors use, if placed outdoors, ensure it is encased in a suitable IP rated external socket or weatherproof box.
- If the unit does NOT operate, ensure that the unit is switched OFF and unplugged prior to attempting to resolve the issue.
- This product must only be used with transformer supplied. Do not connect these lights to the mains or use any other type of transformer. This could create a shock or fire hazard.
- During use, the transformer can become hot. Do not place the transformer on or near flammable objects. It should be located in a well ventilated location.
- Link up to 2 sets (40 lights). Do NOT exceed this stated loading capacity - doing so will invalidate the warranty and could make the units unsafe.
- The lead for the light set can not be replaced, if the lead is damaged, the light set must be recycled in accordance with WEEE directive.

Warranty/ Technical & contact information are all available at www.integral-led.com

ILDEL081_V1



All Trademarks Acknowledged

Integral LED is a division of Integral Memory plc:
Unit 6, Iron Bridge Close, Iron Bridge Business Park,
London, NW10 0UF, UK
Integral Europe BV, 2801 DG, NL